

Reference: **TB 0194 (10/2025)**

# Technical Bulletin

## Installation: Gas and oil boiler pitched roof flashing kit

### INCORRECT INFORMATION FOR FLASHING KIT PART NUMBERS 7716191091 AND 7716191100

When installing a vertical flue for any gas or oil boiler that is using a vertical flue with a pitched roof flashing kit (part numbers above), we advise that the installation instructions are adhered to. There is however, a step included in the flashing instruction which shows a pressure test of the flue. This is **not** a requirement for UK installations.

All other safety measures should be adhered to and any tests that are within current regulations adhered to also.

The figure below shows the installation step that does not need following:

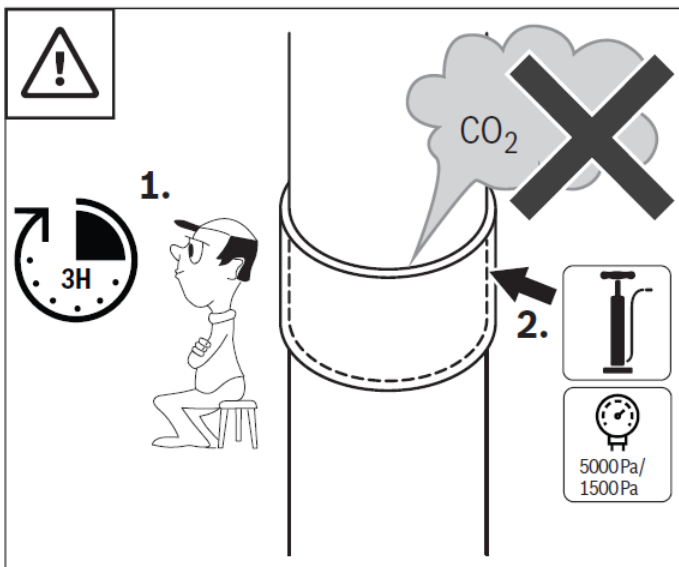

The manual will be updated in due course.

**This information is in addition to the information published in the flue installation manual.**

Whilst it is always our intention to fully assist, it is essential to recognise that all information given by the company in response to an enquiry of any nature is provided in good faith and based upon the information provided with the enquiry. We recommend that advice should always be checked with your installer or contract partner. Consequently, the company cannot be held responsible for any liability relating to the use or repetition of such information or part thereof. In addition, whilst making every reasonable effort to monitor the performance and quality of our supply, installation and service network, we do not accept responsibility for the workmanship or operation of any third party company that the company may have promoted either in conversation, e-mail, or other communication. Similarly, the views and opinions expressed in communication with individuals within the company may not reflect that of the business as a whole.

For all issued technical bulletins, visit the Worcester Bosch website at: [www.worcester-bosch.co.uk/tb](http://www.worcester-bosch.co.uk/tb) or [www.worcester-bosch.ie/tb](http://www.worcester-bosch.ie/tb)

Technical Support: 0330 123 3366 | [technical-advice@uk.bosch.com](mailto:technical-advice@uk.bosch.com)  
**Worcester Bosch, Cotswold Way, Warndon, Worcester WR4 9SW**